



19'6"  
COUPLES

## BRINGING SELF-SUSTAINABILITY TO A NEW LEVEL

Kokoda Caravans are Melbourne made and Australian owned.  
Begin your adventure with a Kokoda.

# COUNTERSTRIKE SERIES COUNTERSTRIKE C196



SLEEPS UP TO 2  
ERGONOMIC  
ELECTRIC BED



KITCHEN  
INTERNAL & EXTERNAL  
INDUCTION COOKTOP



FRIDGE  
INDOOR & SLIDEOUT  
OUTDOOR FRIDGE



LAUNDRY  
LAUNDRY CHUTE &  
WASHING MACHINE



FULL ENSUITE  
SHOWER/ TOILET



BATTERIES  
51v LITHIUM  
BATTERIES



SOLAR  
MASSIVE SOLAR  
CAPABILITY WITH  
OPTIONAL SLIDE-OUT  
SOLAR PANELS

[WWW.KOKODACARAVANS.COM.AU](http://WWW.KOKODACARAVANS.COM.AU)



**COUNTERSTRIKE  
SERIES**

**COUNTERSTRIKE  
C196**



## INTRODUCING OUR COUNTERSTRIKE SERIES

The Counterstrike Series has been a labour of love, meticulously and thoughtfully designed by our clever adventurers who have decades of experience camping in the most difficult yet amazing terrain. We know what you want because we want it too.

This new series is tough on the outside, and luxurious on the inside. Built for durability, capability and an almost fully self-sustainable off-grid camping experience that's not been seen before on Australian roads (or off them).

It's an electric range built right here in Melbourne, in Kokoda's very own factory! Packed full of new features that we guarantee will have you as excited as we are!

Internally, we've covered every thoughtful area which includes ergonomically designed reclining beds, soft close doors/drawers, a dual rubbish bin drawer and a first-of-its kind laundry chute.

Ambient strip lighting and stunningly sophisticated interior colour selections will have you feeling like you're in a 5 Star hotel no matter where you camp.

We are so excited and proud to introduce the first couples model from our new fully electric Counterstrike Series, the Counterstrike C196!

It has features that you didn't know you needed. Rugged on the outside and coated in raptor, this is built to truly stand the test of time and rigours of the Australian Outback.

This van is well thought-out and also gives you the option to add on a toolbox at the front making the van 350mm longer and giving you extra storage if you need it.

The Counterstrike C196 will take off-grid camping to the next level.

### TECHNICAL SPECIFICATIONS

Body Length	20'6"
External Length	8500
Tare (Approx KG)	2,880 - 3,080kg
Ball at Tare (Approx KG)	200kg
ATM (KG)	3,500 - 3,900kg
Payload (Approx KG)	620kg
Internal Height	2000
External Height	3180mm

*\*Please Note: These specifications are an estimate/approx figures.*



**CALL 1800 577 430 OR EMAIL [ENQUIRIES@KOKODACARAVANS.COM.AU](mailto:ENQUIRIES@KOKODACARAVANS.COM.AU)**





**SLEEPS UP TO 2**  
ERGONOMIC  
ELECTRIC BED

## SLEEPING

### THE COUNTERSTRIKE C196 SLEEPS 2

You asked for it. We delivered! Our C196 is fit for royalty with electric adjustable reclining beds and a foam mattress that is ergonomically designed for comfort and support.

You can each control on your own side and the remote even has a massage feature! Being able to control your own side means you can adjust it for your own comfort and to support that bad back you may have. If you're a snorer you can use the zero gravity and sleep with it adjusted slightly upright and both you & your partner can sleep with ease, and you can thank us later!

With large windows and Sirocco fans for each person per bedside & reading light you will find yourself wanting to stay in bed for longer.

Storage isn't shy with a spacious dedicated wardrobe area with the ensuite, as well as overhead storage above the bed, a linen cupboard under the bed and a secret niche beside the bed where you can charge all your devices!

If that wasn't enough there is also a hidden foot locker in the side step!



#### SLEEPING SPECIFICATIONS

Bed	Adjustable reclining beds (electric)
Mattress	Foam Contoured Mattress to enable more comfort and better support
Bedside Niche	Secret Niche under slide-out benchtop with 240vIt DPP & USB / 12vIt Socket (Both Sides)
Foot Locker / Step	Hidden foot locker under the step beside bed
Overhead Cupboards	Ample storage space in overhead cupboards above bed
Reading Light	1 per person at each bedside

**CALL 1800 577 430 OR EMAIL [ENQUIRIES@KOKODACARAVANS.COM.AU](mailto:ENQUIRIES@KOKODACARAVANS.COM.AU)**



## SEATING

### CHOOSE YOUR SEATING STYLE

Our new Counterstrike C196 showcases two reclining chairs in the lounge area, with a table between them that swivels, drops down & can also be removed.

This seating arrangement is not only the most comfortable you will ever experience, but also very practical. Allowing you to sit up to have a meal or get some work done and then lay back & relax after a day exploring. Move it to a spot that suits you & then tie it up with the provided seatbelts when you're on the move.

Once you have recliners, you will not go back!

For those of you who want to entertain and have friends gather 'round the table then you can choose the Straight Lounge with adjustable table. With this option you can also add on a TIC (Table Inlay Cushion) which means you can drop down the table & place the TIC on top creating a sleeping space for that third wheel.

We also offer the traditional option of the Café Dinette, which has a tri-fold table and storage underneath.

No matter which option you choose, you will feel right at home in this new innovative van.



#### SEATING OPTIONS

**CAN CHOOSE 1 FROM THE FOLLOWING 3 OPTIONS:**

1. Straight Lounge	Bench with Telescopic Drop Down Table
2. Café Dinette	with Table
3. Recliners	2 Recliners with removal table between them
Upholstery	Vinyl Leather



## KITCHEN (INSIDE)

### INSIDE COOKING & STORAGE

We know the Counterstrike camper expects the creature comforts of home and the kitchen is no exception. Items often left out but warmly welcomed in this van make themselves useful in a luxurious yet functional area, ensuring this space is a thoughtful compliment.

Providing ample storage space, the durable soft close drawers and cupboard doors lock securely to keep your items in place when travelling and slide out rubbish/recycling bins will keep your living spaces tidy and sanitary. The family chef will feel like they've compromised nothing as the kitchen/dining area is finished with every thought

considered. The waterfall benchtop features an open space with a portable induction cooktop that can be neatly put away in the many drawers creating a spacious prep area. With slide out half pantry, large sink with a pull-down spray tap and flick mixer cooking will be a dream.

An optional convection oven is available for those of you who just can't go without your Sunday roast or baking a cake for loved ones on those special occasions and all the necessary ingredients will easily fit in an accommodating 274 litre Thetford compressor fridge.



#### KITCHEN INSIDE SPECIFICATIONS

Cooktop	Portable Induction Cooktop
Range Hood	Sphere Recessed
Microwave	240vIt
Tap	Flick Mixer with Pull down Vegetable Sprayer
Cupboards	Light Weight & UV Resistant with Rectangle Push Buttons & Hidden Overhead Handles
Drawers	Titus Tekform Runners
Bench Top	Laminate with Waterfall Edge (Square Edge)
Pantry	Half (Slide-Out)
Fridge / Freezer	Thetford 274 Litre 2 way

**CALL 1800 577 430 OR EMAIL [ENQUIRIES@KOKODACARAVANS.COM.AU](mailto:ENQUIRIES@KOKODACARAVANS.COM.AU)**





## OUTSIDE LIVING

### EXTERNAL KITCHEN / LIVING

The design of the C196 external kitchen was an exciting addition to our Counterstrike Series. A large drop-down table neatly reveals spacious pantry shelves, flick mixer tap with a portable basin which can neatly be tucked away when not in use, and a 240v portable induction cooktop, which is gaining popularity over the bulkier pull out gas cook tops that... let's face it... take up a massive amount of storage space and require a gas flame that can't compete with even the slightest breeze.

The large electric awning will keep you protected from the elements while you relax and enjoy the outdoor entertaining area with those that mean the most to you.

A mount plate for the 32" smart TV is conveniently tucked into the recession of the pantry area because we know that at some point you're going to want to watch the latest release or catch that game you've been waiting for.

Dusk and dawn are no worries with the large LED strips that offer bright white and amber anti-bug lights with switch or convenient remote-control use.

Combine the above with a custom fit dual-compartment 80 litre pull out EvaCool fridge and the entertainment is endless.



#### OUTSIDE LIVING SPECIFICATIONS

Counterstrike Outdoor Kitchen	Fold Down Kitchen under Awning with Pantry Shelves
Portable Induction Cooktop	240v Portable Induction Cooktop
Basin	Portable
Tap	Flick Mixer
Fridge / Freezer	80 litre EvaCool Fridge / Freezer Located in oversized front tunnel boot (in the Counterstrike front box if optional)
TV Wall Mount Plate	Inside Fold Down Kitchen Hatch
Awning	Electric With Internal buttons and Remote

**CALL 1800 577 430 OR EMAIL [ENQUIRIES@KOKODACARAVANS.COM.AU](mailto:ENQUIRIES@KOKODACARAVANS.COM.AU)**



# COLD STORAGE

## INDOOR & SLIDEOUT OUTDOOR FRIDGES

The Counterstrike C196 will take care of your every need, including indoor & outdoor fridges. You won't go hungry or thirsty again!

Internally, the C196 provides a Thetford 274 litre Dometic compressor fridge. This has NO gas, which means you don't have to worry on your long travels and when you're in hot climates. This fridge will keep everything cool, whether you're parked up or driving. It is also quite generous with plenty of space for food for everyone.

Externally this van showcases even more cold storage with a custom fit dual-compartment 80 litre pull out EvaCool fridge. This has been designed and built to fit in this space perfectly, so you don't need to worry about tying it up or how it will travel. Not only that, this whole compartment is insulated!

Talk about convenience, you no longer have to run back in to grab a cold drink or snack! Your entertainment is endless, just like your cool beverages will be.



### FRIDGE SPECIFICATIONS

Internal Fridge / Freezer	Thetford 274 Litre 2 way
External Fridge / Freezer	80 Litre EvaCool Fridge / Freezer Located in oversized front tunnel boot (in the Counterstrike front box if optioned)



**LAUNDRY**  
LAUNDRY CHUTE &  
WASHING MACHINE

# LAUNDRY

## LAUNDRY CHUTE & WASHING MACHINE

Comfort and convenience is synonymous with our Counterstrike Series and we are so proud to introduce an industry first with our Counterstrike Series.

Cleverly designed through years of experiencing picking clothes up from the floor and moving them from place to place, our ensuite laundry chute is the smartest spot to drop those dirty items when they're no longer fit for wear.

The Laundry Chute is hidden in the Ensuite and with the

click of a button the top slides out for you to hide those dirty items.

It's easily accessible from the outside of the van and it's a seamless transition to the 3.5kg washing machine which is right next door to the laundry chute.

Streamlining your washing and helping you stay organised when you're on the road. The C196 will have you saying "where have you been all my life?!"



### LAUNDRY SPECIFICATIONS

Washing Maching	3.5 Litre Front Loader (Outside)
Laundry Chute	Hidden slide laundry chute
Hot Water Service	20 Litre Electric
Ceramic Basin	White (Ensuite)
Mirror	Wall Mounted (Ensuite)

**CALL 1800 577 430 OR EMAIL [ENQUIRIES@KOKODACARAVANS.COM.AU](mailto:ENQUIRIES@KOKODACARAVANS.COM.AU)**





**FULL ENSUITE  
SHOWER/ TOILET**

## BATHROOM + WARDROBE

### FULL ENSUITE WITH SHOWER & TOILET

The Counterstrike C196 has a luxuriously spacious ensuite complimented by the “walk in wardrobe” feature of having what was once a bedside wardrobe incorporated into the space. Makes sense doesn't it? We think so, too!

Generous overhead storage and a massive amount of bench space compliments the lower storage cupboards and drawers. The clever, full height wardrobe & closet is just an arms length from the shower making your morning and evening routines as convenient as possible.

This is also where our fan favourite resides. The laundry chute is accessible via a cleverly designed slide out which means no compromising on bench space to access it.

Tucked neatly behind the acrylic ensuite door, the Thetford swivel toilet is fitted with a SOG system that will eliminate unwelcome odours from your cassette tank via a carbon filter.

This walk-in ensuite/closet is sure to please all passengers on board.



#### BATHROOM SPECIFICATIONS

Robe	Full Height with Drawers, Robe with Shelves
Overhead Cupboards	Ensuite with hidden handles
Toilet	Cassette with toilet roll holder
Shower	Fibreglass with towel hooks to hold 4x towels
Ceramic Basin	White (Ensuite)
Mirror	Wall Mounted (Ensuite)
Hot Water Service	20 Litre Electric
Shower Rail	Adjustable
Grey Water	40 Litre Portable Bladder

**CALL 1800 577 430 OR EMAIL [ENQUIRIES@KOKODACARAVANS.COM.AU](mailto:ENQUIRIES@KOKODACARAVANS.COM.AU)**



## EXTERNAL STORAGE

### RAPTOR COATING AND STORAGE ALL AROUND

The Raptor Coated exterior of our Counterstrike series has some stand-out features. Most notable are the front and rear boxes that are as tough as they are functional. The front box on our C196 leads the way with an external stone guard/triple compartment open storage.

Perfect for your sullage hoses, fire wood and drop down jockey foot. Beside that on the awning side of the van, you'll find a massive tunnel boot, with an insulated slide out featuring a 80 litre custom fit EvaCool, dual-compartment fridge/freezer which also provides ample storage behind that you can access from the non-awning side.

On the non-awning side you will also find our fan favourite feature the cleverly placed washing machine securely stowed next to the (first of its kind) laundry chute which is accessible from the ensuite. With extra cubby spaces for your washing goods, this is fabulous addition is a long-overdue feature for savvy campers on the go.

This van is well thought-out and also gives you the option to add on a toolbox at the front making the van 350mm longer and giving you extra storage if you need it.

Bringing up the rear of our C196 you will find two full size spare tyres mounted next to dual jerry can holders and above the secure drop-down storage.

You can now fit everything you need within the van storage compartments, which means nothing needs to be stored in your tow vehicle anymore.

The rear box can store all tools and power equipment, so you are always prepared for any situation you come across.

We also have an upgrade optional extra you can add on for extra lockable storage under the van next to both sides of the wheels that make for great little toolboxes.



#### EXTERNAL BOXES SPECIFICATIONS

Raptor Coating	Front, Sides, Front / Rear Boxes & Chassis
Oversized Tunnel Boot	Insulated for better Fridge Operation, Slide-Out Brackets for Built in 80 litre 12v Fridge & Additional Storage Space Behind (access from non-awning side).
Counterstrike Rear Bar	Drop Down Storage Box, Remote Operated Reverse Light / Rear Work Light
Counterstrike Front Box	Angled Storage Tubs at Front of Van (Can option on Toolbox at front as pictured)
Under Toolbox	Optional upgrade for small toolboxes under van
Jerry Can Holders	2 x 20Ltr in Counterstrike Rear Bar
Spare Wheels	2 x Mounted on Rear

**CALL 1800 577 430 OR EMAIL [ENQUIRIES@KOKODACARAVANS.COM.AU](mailto:ENQUIRIES@KOKODACARAVANS.COM.AU)**





## EXTERNAL LIGHTING

### LIGHT ME UP!

You can light up the Counterstrike C196 easily and quickly with the push of a remote button.

Featuring 5x awning and non awning side white/amber lighting, and 2x 26" LED bar lights at the front and rear you will never be left in the dark again!

These lights are fantastic for use around the campsite, and a big hit when travelling in the dark to spot wildlife and be able to see all sides of the van when traversing some off road locations to get to your secluded spot.

The amber lighting is a favourite with us and what we usually use, as amber lights are known for emitting a warm, orange-ish light that is less attractive to insects, including mosquitoes and moths - and we can vouch they actually work in doing this!

The brightness, especially in the dark is amazing, with a push of a button you can see for miles all around you. You simply won't be able to go past the convenience this van has to offer with many features.



#### EXTERNAL LIGHTING SPECIFICATIONS

Light	4 x LED White / Amber Bug Lights
Light	1 x LED White / Amber Bug Light above External Kitchen
Light	Water Proof with Switch - Tunnel Boot
Light	LED Door Handle
Flood Bar Lights	26" Front and Rear Lights

**CALL 1800 577 430 OR EMAIL [ENQUIRIES@KOKODACARAVANS.COM.AU](mailto:ENQUIRIES@KOKODACARAVANS.COM.AU)**



**POWER  
GENERATION**  
MASSIVE SOLAR  
CAPABILITY WITH  
OPTIONAL SLIDE-OUT  
SOLAR PANELS

# POWER GENERATION

## POWERING THE COUNTERSTRIKE

Counterstrike's take off-grid capabilities serious. So much so that we've built the Counterstrike Series to take off-grid to the next level being as self-sufficient as possible.

Our standard line provides a 7.1KW 51v lithium storage, 1.65kw of solar capacity by way of 4 X 415w panels and a 5kw inverter to make everything seamless.

What does that mean for you? Let's simplify it...

Our system runs on higher (51) voltage than traditional, far less efficient set ups do. This allows you to run your appliances solely on solar (providing there is some or full sun) without needing to invert your battery.

This equates to being able to run your appliances for a considerable amount of time with NO solar input. That means you can keep on living like you do at home on the road.

Double those hours if you upgrade to our Take Charge System and you'll never want to go home! Worried about those 40 degree days and 30 degree nights? Not with the Counterstrike Series!

We know you'll love the power capabilities the Counterstrike Series provides as much as we do!



### POWER SPECIFICATIONS & UPGRADE OPTIONS

Solar Panels	4x 400w 70v Panels
Upgrade Slide-Out Solar	Take Charge System
Battery Power	51v 7.1kw Lithium under chassis, with Dual Fire Supression System
Power	240V Weather Proof Outlet (Single)
Power	12V Weather Proof 12vlt Socket

**CALL 1800 577 430 OR EMAIL [ENQUIRIES@KOKODACARAVANS.COM.AU](mailto:ENQUIRIES@KOKODACARAVANS.COM.AU)**





**COUNTERSTRIKE  
SERIES**

**COUNTERSTRIKE  
C196**



# TAKING YOU OFF-ROAD

## DRIVING ON ROAD, ON TRACK & OFF ROAD

We know you want to be able to navigate every road possible in your Counterstrike C196. And we know you want to do it with confidence and style. From high speeds on the bitumen, corrugated loose stone roads and those rutted tracks you're keen to get over and through to find the best spots out there.

The C196 offers a level 4 air bag system which provides smoother travel on every type of road but a clear stand out on corrugated roads or sandy beaches.

In these circumstances you'll usually want to drop your tyre pressure significantly for optimal, and safe travels. And it's not just the pressure on your van, but your tow vehicle as well.

With the on-board compressor and holding tank you are capable of managing your tyre pressures with confidence

and ease without needing to rely on finding the nearest petrol station... which can often be hours away when camping off-grid in some of Australia's amazing remote areas.

With a BOS jockey wheel, you no longer need to wind the jockey foot by hand, and it travels in place so storing such a heavy bulky item is not a concern.

Raise the van with the push of a remote button to gain clearance over spoon drains, ruts or rocks and lower it when you need to avoid those low branches that get in your way. Auto-level or individually adjust when you park up to find your sweet spot.

The Counterstrike C196 is taking camping to a whole new level, creating ease for you and allowing you more time to enjoy the great outdoors.



**CALL 1800 577 430 OR EMAIL [ENQUIRIES@KOKODACARAVANS.COM.AU](mailto:ENQUIRIES@KOKODACARAVANS.COM.AU)**



## COUNTERSTRIKE C196 SPECIFICATIONS

INTERNAL	
Bed	Adjustable reclining beds (electric)
Mattress	Foam Contoured Mattress to enable more comfort and better support
Toilet	Cassette with toilet roll holder
Shower	ABS with towel hooks to hold 4x towels
Ceramic Basin	White (Ensuite)
Taps	Flick Mixer with Pull down Vegetable Sprayer
Robe	Full Height with 3 x Drawers, Robe with Shelves
Niche	Secret Niche under benchtop with 240vlt DPP & USB / 12vlt Socket (Both Sides)
Mirror	Wall Mounted (Ensuite)
Overhead Cupboards	Kitchen, Lounge, Ensuite & Master
Magazine Pocket Holder	Medium
Drawers	Titus Tekform Runners
Bench Top	Laminate with Waterfall Edge (Square Edge)
Splash Back Kitchen	Full Height
Pantry	Half (Slide-Out)
Cupboard Doors	Light Weight & UV Resistant
Handles	Rectangle Push Button
Overhead Handles	Hidden
Door	Dometic Triple Lock with sep Security Screen with Built in Blind
Floor Vinyl	Durable Modern Design with Protective Coating
Windows	Double-Glazed

SEATING OPTIONS	
CAN CHOOSE 1 FROM THE FOLLOWING 3 OPTIONS:	
1. Straight Lounge	Bench with Telescopic Drop Down Table
2. Café Dinette	with Table
3. Recliners	2 Recliners with table between them
Upholstery	Vinyl Leather
APPLIANCES	
Fans	12v Fans, 1x per person Bed and 1x at Seating
Range Hood	Sphere Recessed
Internal Fridge / Freezer	Thetford 274 Litre 2 way
External Fridge / Freezer	80 Litre EvaCool Fridge / Freezer Located in oversized front tunnel boot (in the Counterstrike front box if optioned)
Hot Water Service	20 Litre Electric
Microwave	240vlt
TV & Bracket	32" Smart TV with 2 Arm Mount
Air Conditioner	Truma Aventa
Stereo	2x Portable Bluetooth speakers that can play simultaneously
Cooktop	Portable Induction Cooktop
Washing Machine	3.5 Litre Front Loader (outside)
PLUMBING	
Shower Rail	Adjustable
Sink	Single Bowl
Sink Tap	With Retractable Hose
Water Tanks	2 x 110Ltr
Tank Fillers	Fast Fill Points
Tap	On A-Frame
Grey Water	40 Litre Portable Bladder



## Our new Counterstrike Series is going to blow you away!

This range is innovative and built for truly long term off-grid camping experiences. A durable sandwich foam construction provides peace of mind and reliable insulation. This fully electric van has features we guarantee you have not seen before.

Designed to be almost fully self-sustainable with our innovative option to upgrade to the "Take Charge" solar panel system that doubles your solar intake with a simple slide out via the click of a button. Auto-levelling from your mobile phone, rear recovery points, rear departure angles for the tightest spots. Further features include our under chassis and outside guards, fast fill system for our standard 2x110ltr tanks, composite flooring and a 80ltr Evacool slide out fridge. Raptor Coated chassis and front/rear Counterstrike Box, both featuring exceptional storage capabilities and 17" Mickey Thompson tyres will have everyone turning their heads to get a second look.

### INTERNAL ELECTRICAL

Lighting	LED Down Lights
Power Points	240vlt DPP (Master Bed, Lounge, Kitchen, Ensuite)
Reading Light with USB Port	1 Per Persons Bed & 2 at Lounge
Invertor	5000w Invertor Charger
Water Tank Gauge	
SOG Toilet Fan	with External Carbon Filter

### EXTERNAL ELECTRICAL

Light	4 x LED White / Amber Bug Lights
Light	1 x LED White / Amber Bug Light above External Kitchen
Light	Water Proof with Switch - Tunnel Boot
Light	LED Door Handle
Power	51v 7kw Lithium under chassis, with Dual Fire Supression System
Power	240V Weather Proof Outlet (Single)
Power	12V Weather Proof 12vlt Socket
Solar Panels	4x 400w 70v Panels
Brakeaway	Unit & Switch
Cameras	Front & Rear Camera (2)
Flood Bar Lights	26" Front and Rear Lights

### EXTERNAL

Awning	Electric With Internal buttons, Remote and phone app
Step	Double Pull-Out (Manual)
TV Wall Mount Plate	Inside Fold Down Kitchen Hatch
Counterstrike Kitchen	Fold Down Kitchen under Awning, with Portable 240v Induction Cooktop, hot & cold tap, TV mount
Counterstrike Rear Bar	Drop Down Storage Box, Remote Operated Reverse Light / Rear Work Light
Counterstrike Front Box	Angled Storage Tubs at Front of Van
Jerry Can Holders	2 x 20Ltr in Counterstrike Rear Bar
Spare Wheels	2 x Mounted on Rear
Jack	Hydraulic
Jockey Stand	Bos 3 ribbed Battery Drill Operated, with Foot not Wheel (standard jockey included too)

### CHASSIS & SUSPENSION

Suspension	Tuff Ride 3.5t to 4t ATM Level 4 Airbag System with OnBoard Compressor & Tank
Wheels	17" Alloy
Tyres	BFG or Mickey Thompson Off-Road M/T
Hitch	DO35 / DO45
Chassis	6" DuraGal
A-Frame	6" DuraGal
Axle	Dual
Rear Recovery Points	

### PROTECTION

Raptor Coating	Front, Sides, Front / Rear Boxes & Chassis
Water tank guards	Sheet Metal
Under Chassis Stone Flaps	x2 Under Chassis Rubber Guard to Protect from Stones

### CONSTRUCTION

Frame, insulation & cladding	Fibreglass Insulated Composite Panel, Walls, Front, Rear & Roof
Flooring	Fibreglass Insulated Composite Flooring

# COUNTERSTRIKE C196

## RECLINERS FLOORPLAN

STANDARD LAYOUT

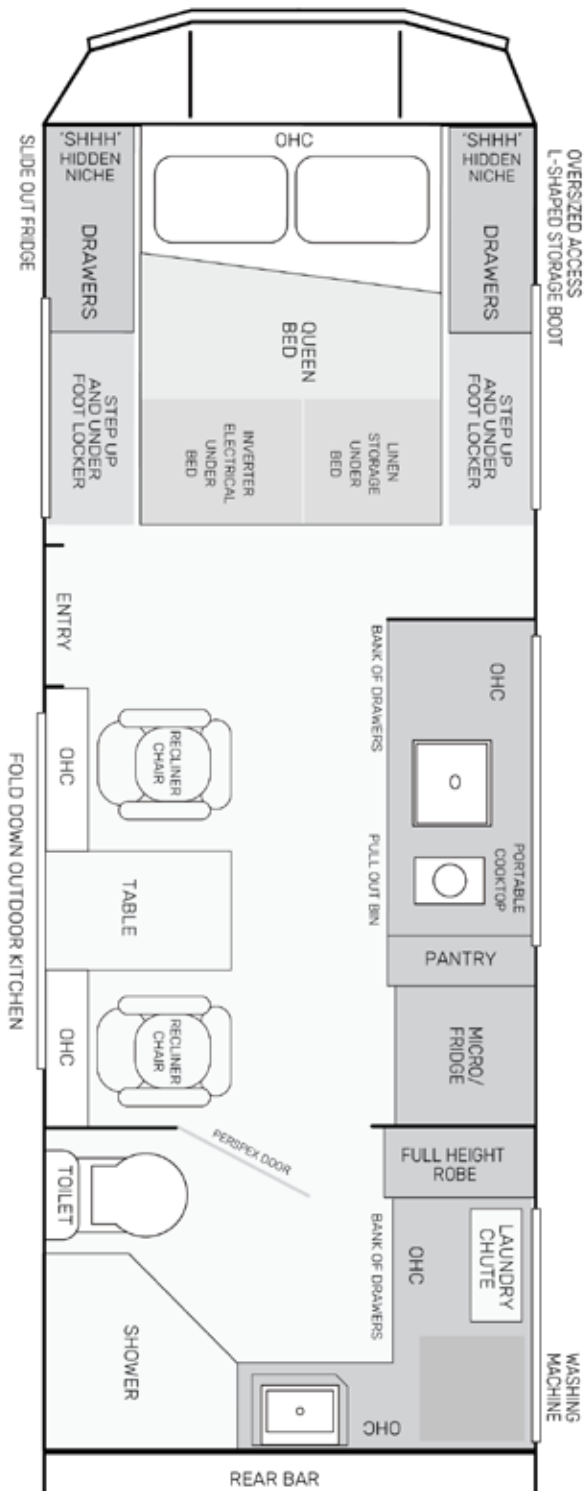

TOOLBOX LAYOUT (OPTIONAL UPGRADE)  
THE VAN WILL BE 350MM LONGER WITH THE TOOLBOX

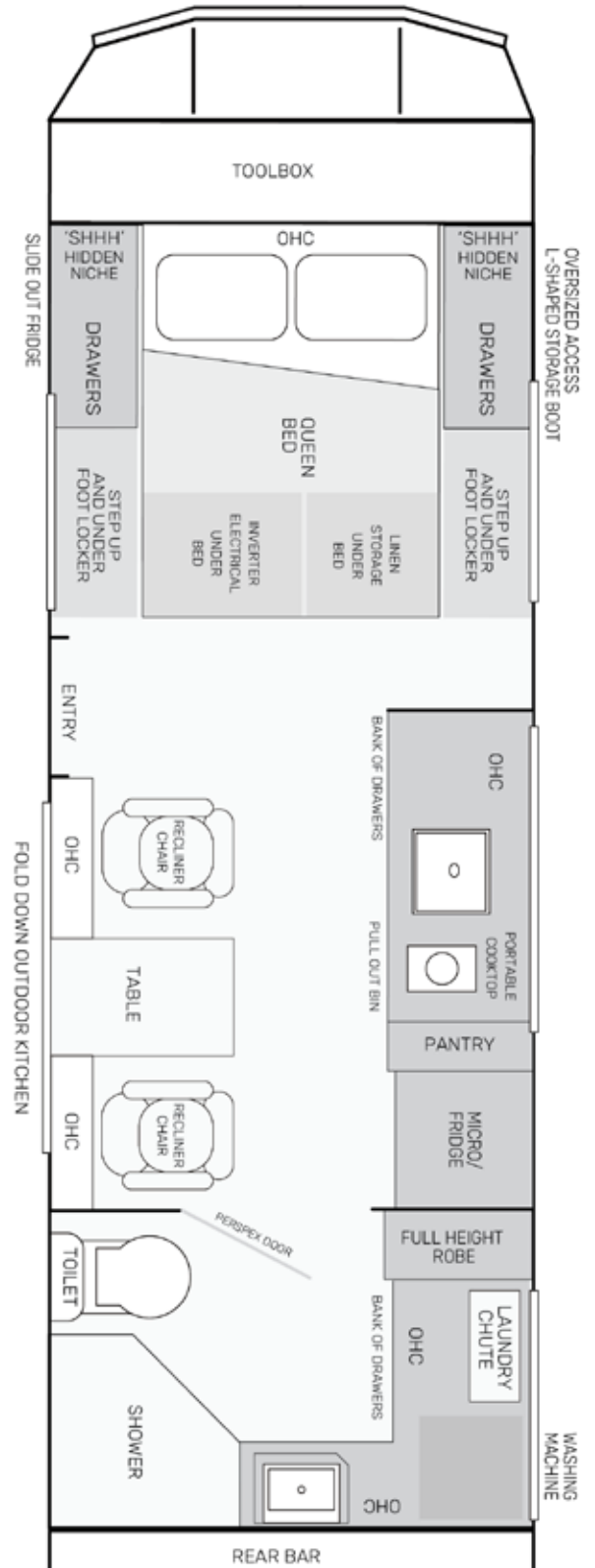



# COUNTERSTRIKE C196

## CAFE DINETTE FLOORPLAN

STANDARD LAYOUT

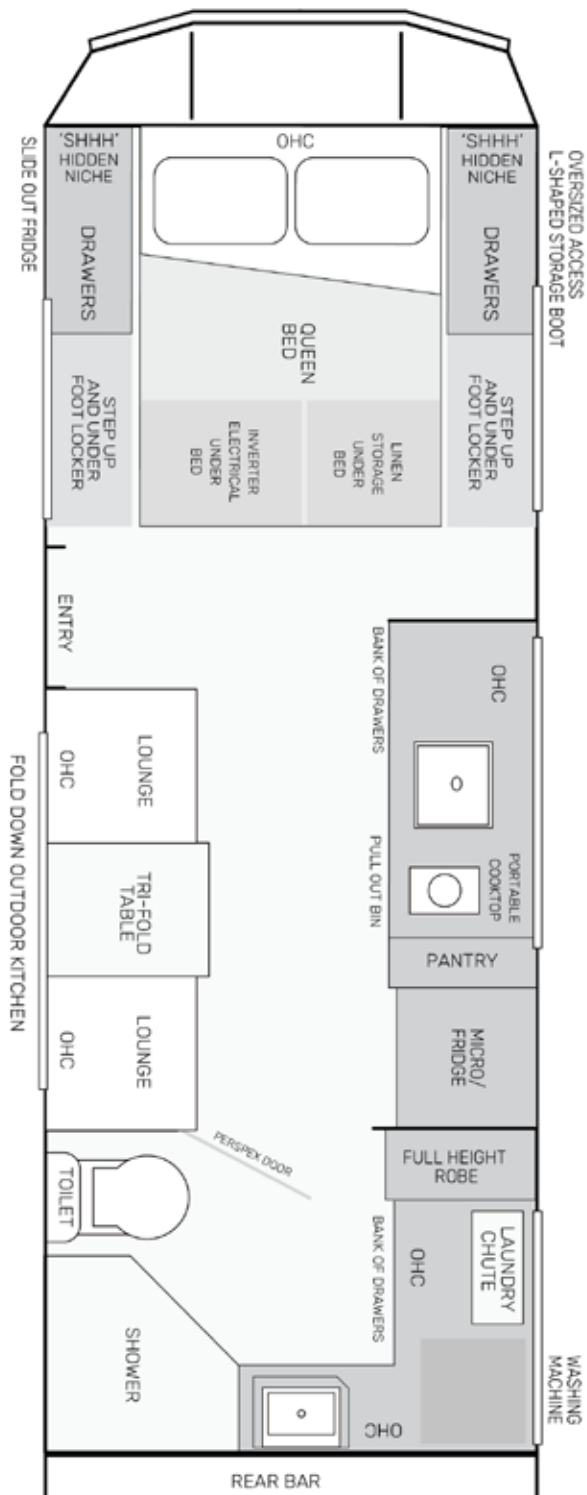

TOOLBOX LAYOUT (OPTIONAL UPGRADE)  
THE VAN WILL BE 350MM LONGER WITH THE TOOLBOX

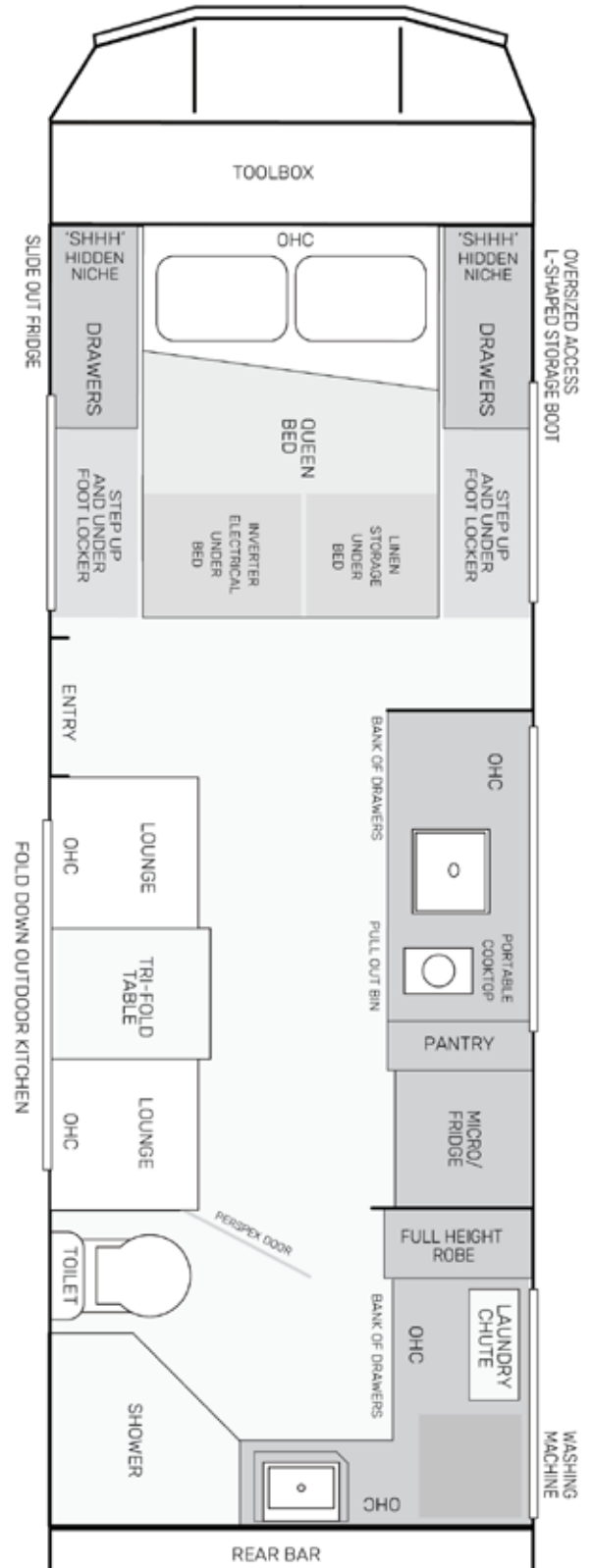

# COUNTERSTRIKE C196

## STRAIGHT LOUNGE FLOORPLAN

STANDARD LAYOUT

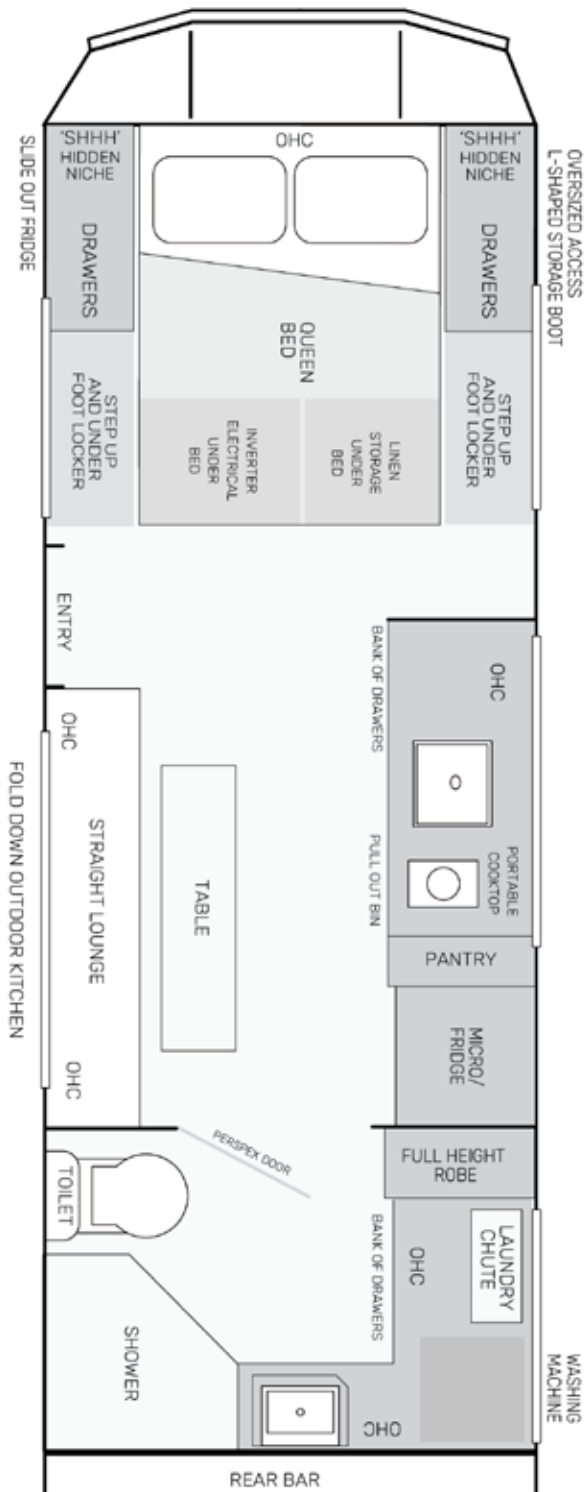

TOOLBOX LAYOUT (OPTIONAL UPGRADE)  
THE VAN WILL BE 350MM LONGER WITH THE TOOLBOX

